



21 Hazel Street Horsham VIC

3 1 1

Very rarely do homes receive the love and attention that this one has. As neat as a pin and lovingly maintained, this is a great starter home or shrewd investment opportunity. Overlooking Elbourne Park and enjoying shared private access from a sealed service road, the setting is ideal and the options are endless. Features include a neat kitchen, gas heating, three bedrooms, external cladding, a single car shed and a tidy yard, making this a comfortable home as it is. The block and its surroundings also suggests a quality two-unit development (STCA).

Price : \$ 115,000

View : <https://www.wdre.com.au/6517846>



Wes Davidson
0419820000



WES DAVIDSON
REAL ESTATE

21 HAZEL STREET
HORSHAM

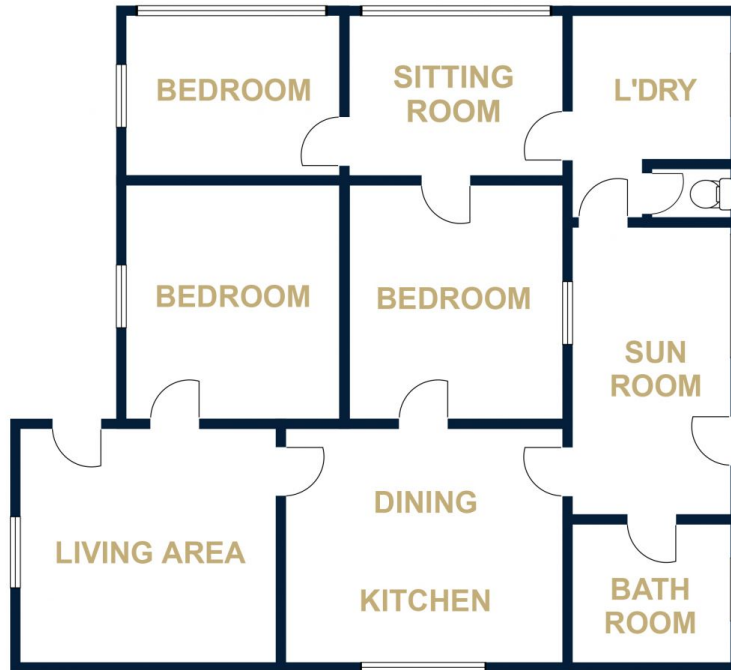

FLOOR PLANS/SITE PLANS ARE INTENDED AS A GENERAL GUIDE ONLY. NO REPRESENTATIONS OR WARRANTIES OF ANY NATURE WHATSOEVER ARE GIVEN OR INTENDED AND ANY PERSON USING THIS INFORMATION SHOULD ALWAYS RELY ON THEIR OWN ENQUIRIES.